

AI Translation Scheduling

Set start and end time depending on when you want the AI to run.

Features

Live Translation

Admin

Next to the other start/stop options (Automatically with source channel, manual start of each channel) you can schedule when AI Translation should start and stop.

When setting up an AI Translation channel you will be asked which start option you want to choose.

If you select "Scheduled" you will be able to define date and times for start and end.

You can add several dates/times according to your needs.

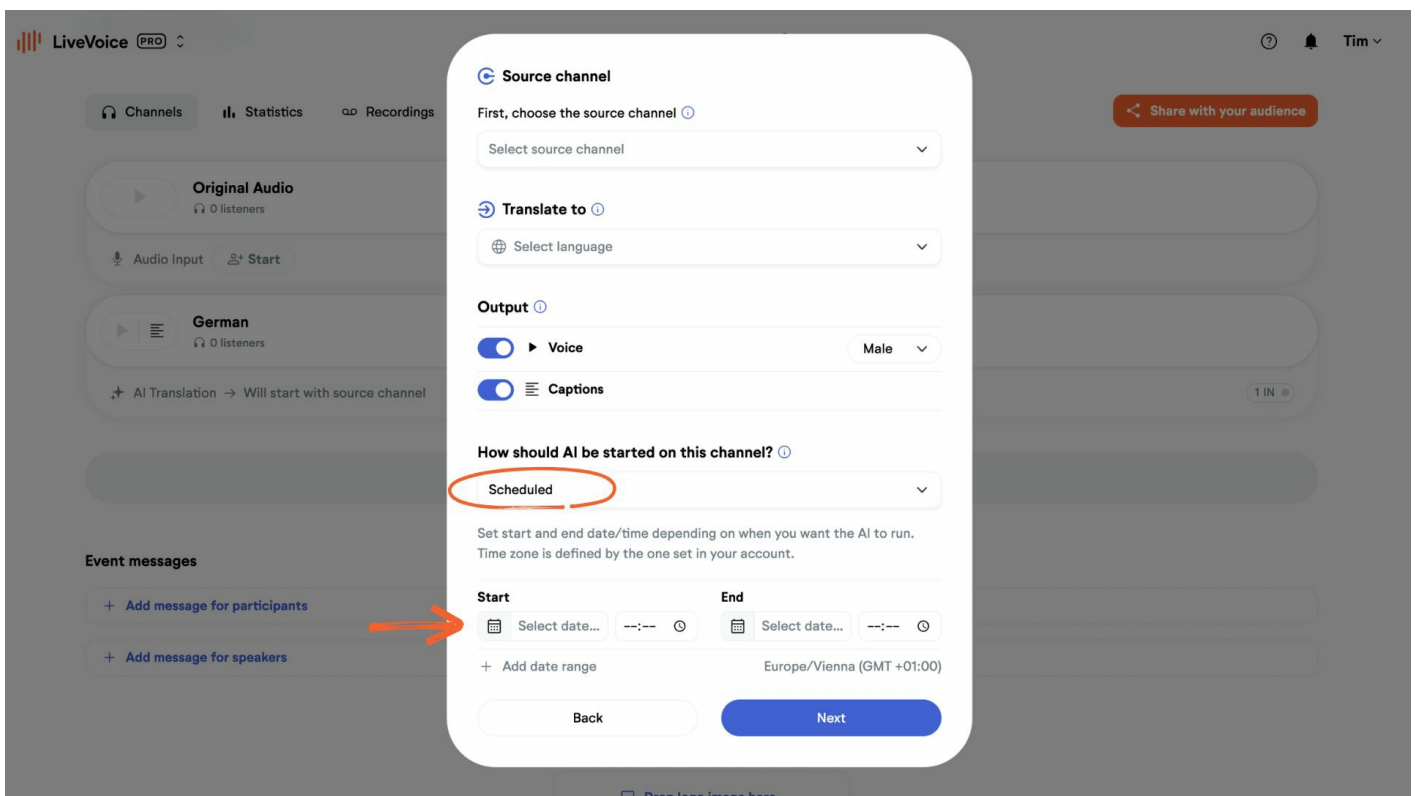

 Time zone is defined by the one set in your account.