

Interpreters: Using LiveVoice with MS Teams

What you need to know when using LiveVoice as an interpreter for a Teams Meeting.

[Useful tips](#)[Live Translation](#)[Speaker](#)

Interpreters who want to do interpretation of MS Teams meetings need to mute their mic input on Teams, while speaking into LiveVoice.

However, depending on the headset used, Teams might mute the *whole* headset, which results in the situation that no audio gets into the mic at all - which means also no audio gets into LiveVoice of course.

In such cases, interpreters can choose one of these options:

1. 1.

Use another headset: We recommend a headset with 3.5 mm jack, instead of USB headset, because classic 3.5 mm jack headsets can not be muted by Teams.

2. 2.

Choose another Mic Input in Teams: Do not chose the headset in Teams that you will use with LiveVoice. In this way, if Teams mutes this Input, it does not affect your actual mic.

If Floor audio comes via LiveVoice:

Simply don't connect to Teams audio at all, using only video.

When logging in to Teams, follow these steps:

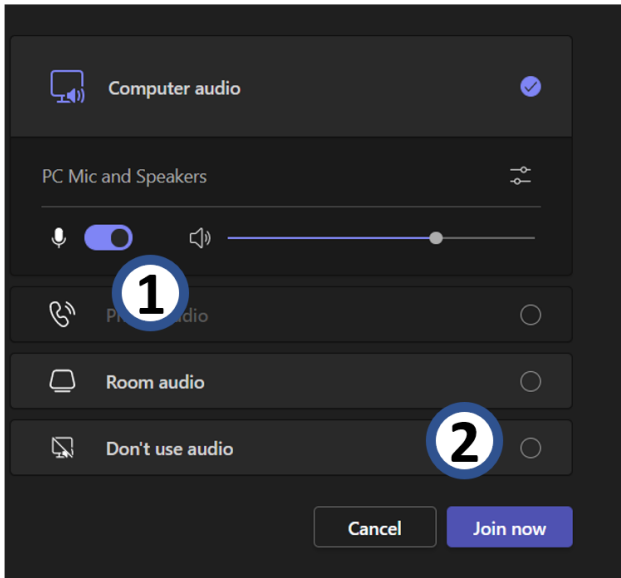

- 1) Mute Microphone
- 2) Select “Don’t use audio”

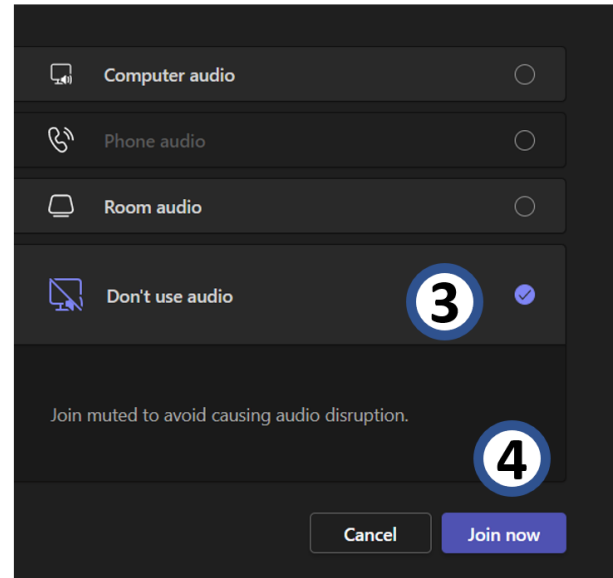

- 3) Verify “Don’t use audio” is selected
- 4) Select “Join Now”