

Create events & channels

Setting up events and channels is a breeze. Access your LiveVoice admin account in your web browser and follow these steps.

- Basics
- Live Translation
- Guided Tours
- Silent Conferencing
- Audio Description
- Admin

Step 1: Create a new event

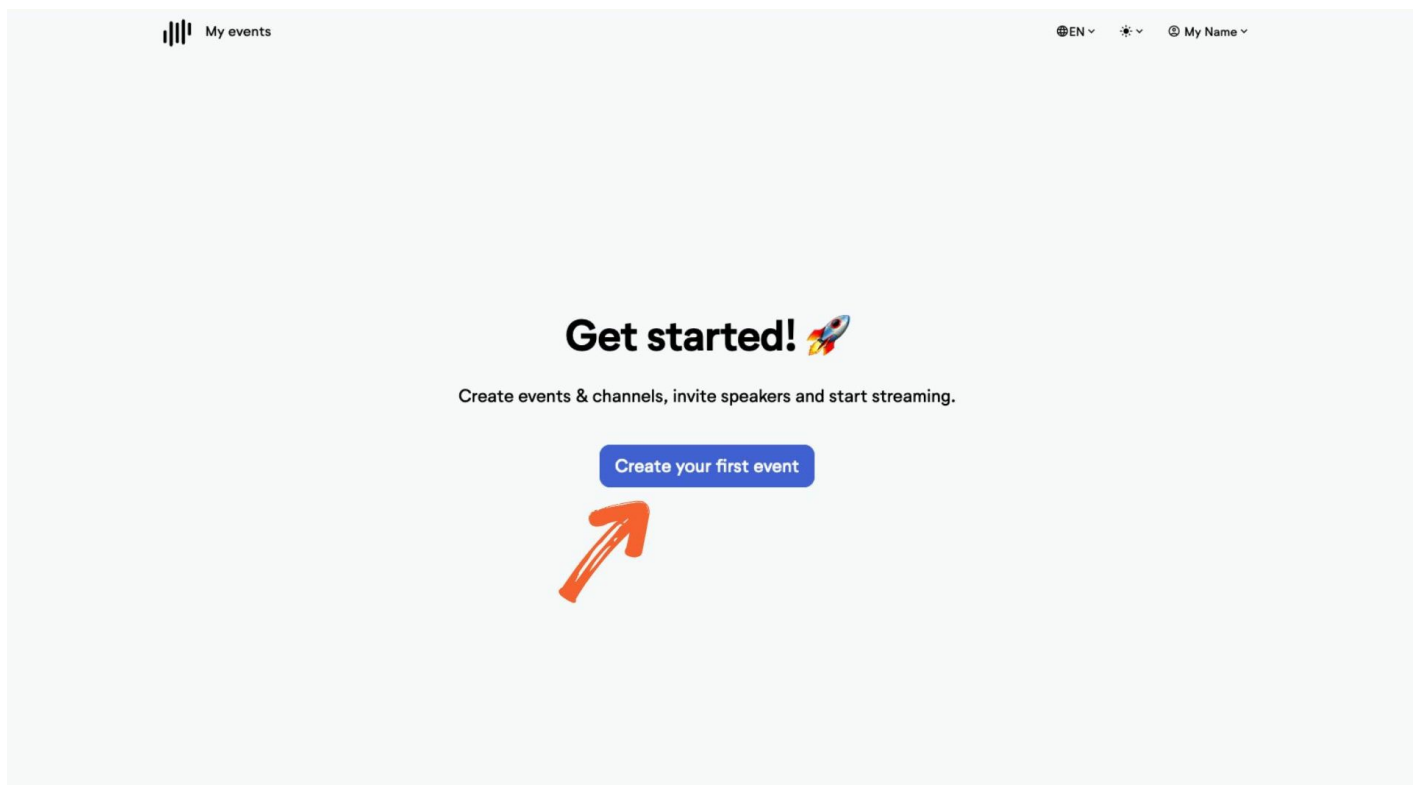

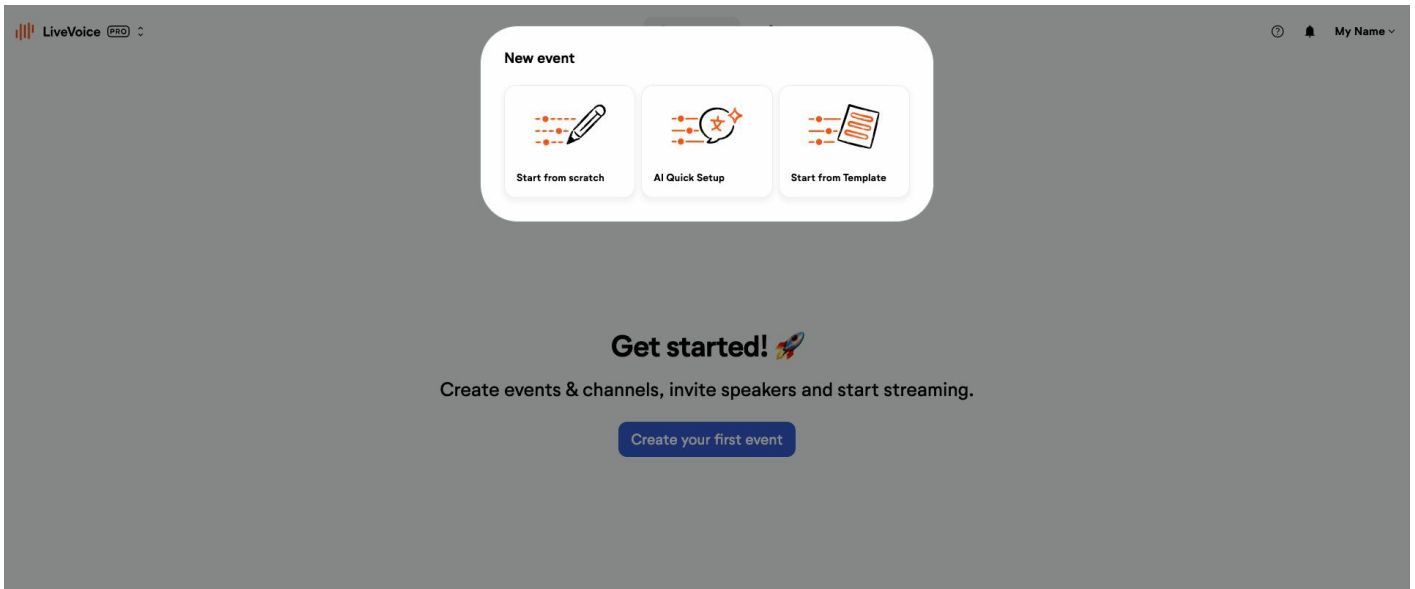

Option 1: Start from scratch

Set up your event manually without any default settings.

Option 2: AI Quick Setup

Use a guided setup to get AI translation running in just three steps. Learn more about how to set up AI translation [here](#).

Option 3: Start from Template

Choose from pre-built templates to quickly set up your channels for common use cases, such as Translation On Site, Remote Translation, or Guided Tours. You can edit the event after creating it anytime.

Step 2: Create channels

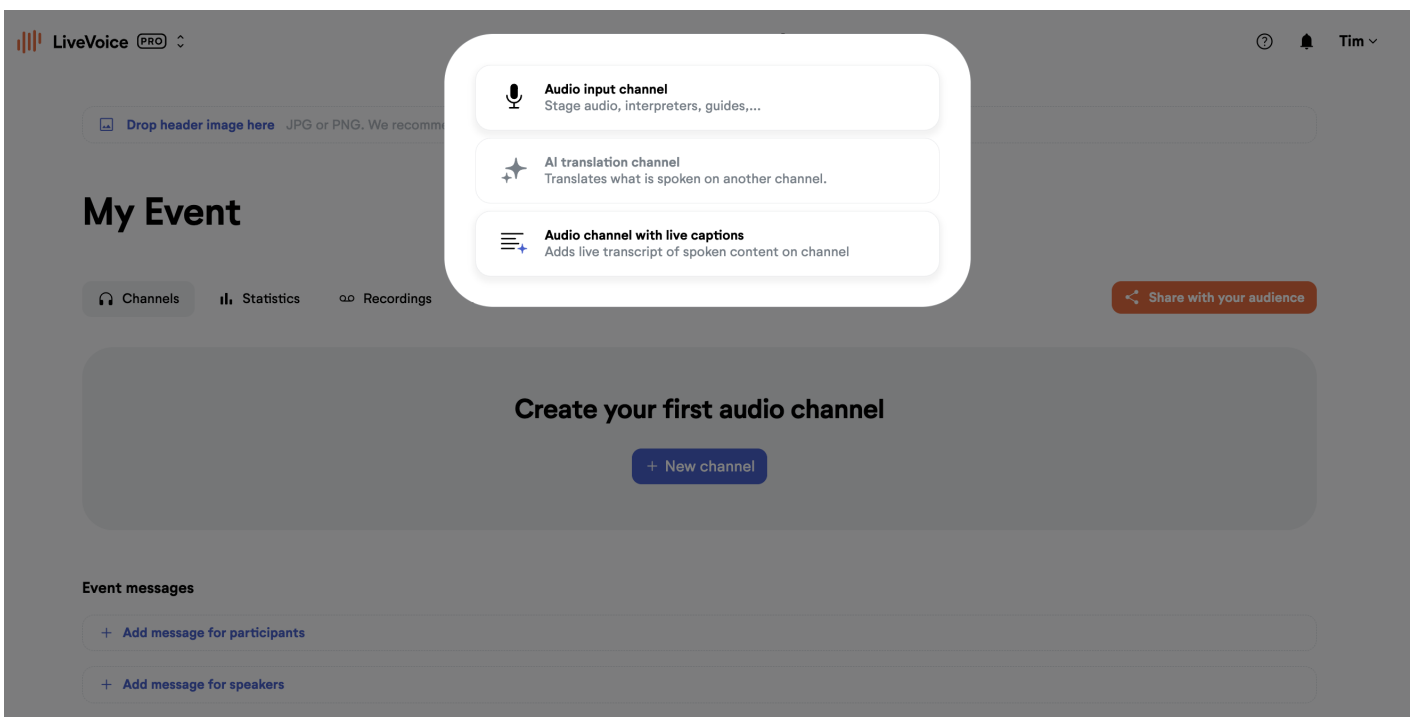

You can choose from 3 options:

- **Audio Input:** For Original Audio from stage, Interpreters, Tour Guides etc.
- **AI Translation:** For Voice and/or Text translation channels
- **Audio Input with Live Captions:** To provide a live transcript of the channel audio

Before you can add an AI Translation channel, you will need to create at least one audio channel. This is why at first the AI Translation channel option is greyed out.

Step 3: Edit channels or add more features

Once you have created a channel, you can edit the features of it anytime by clicking "Show options", then adding features or editing/removing them.

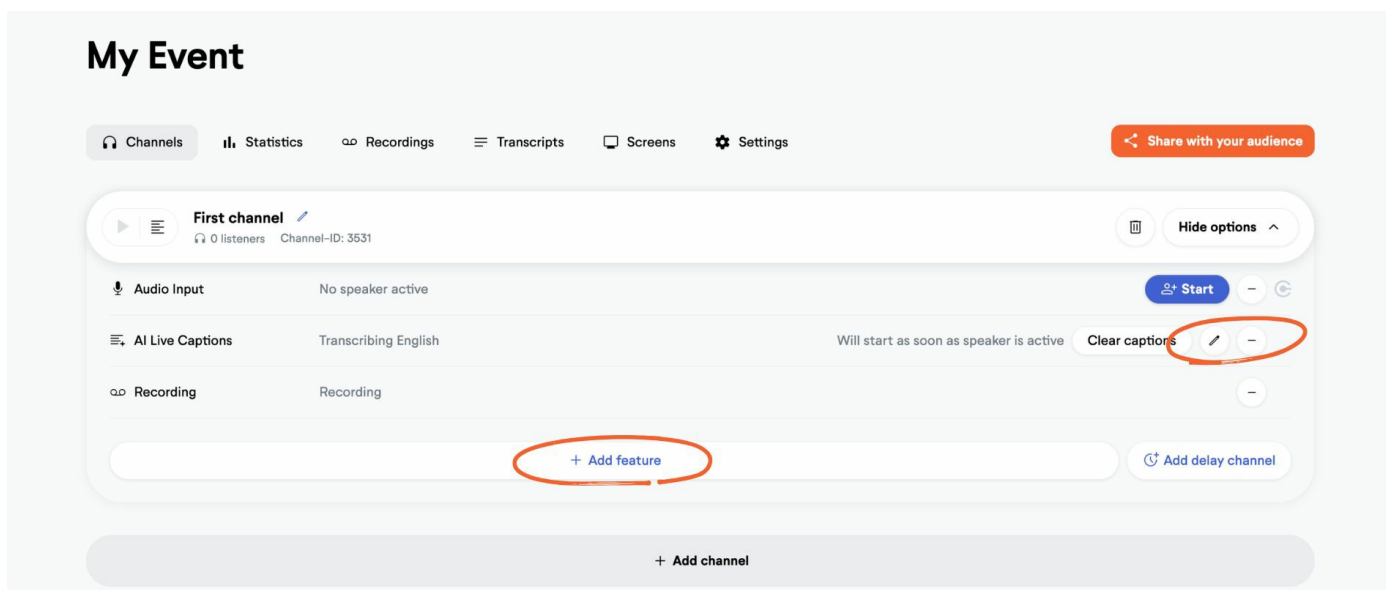
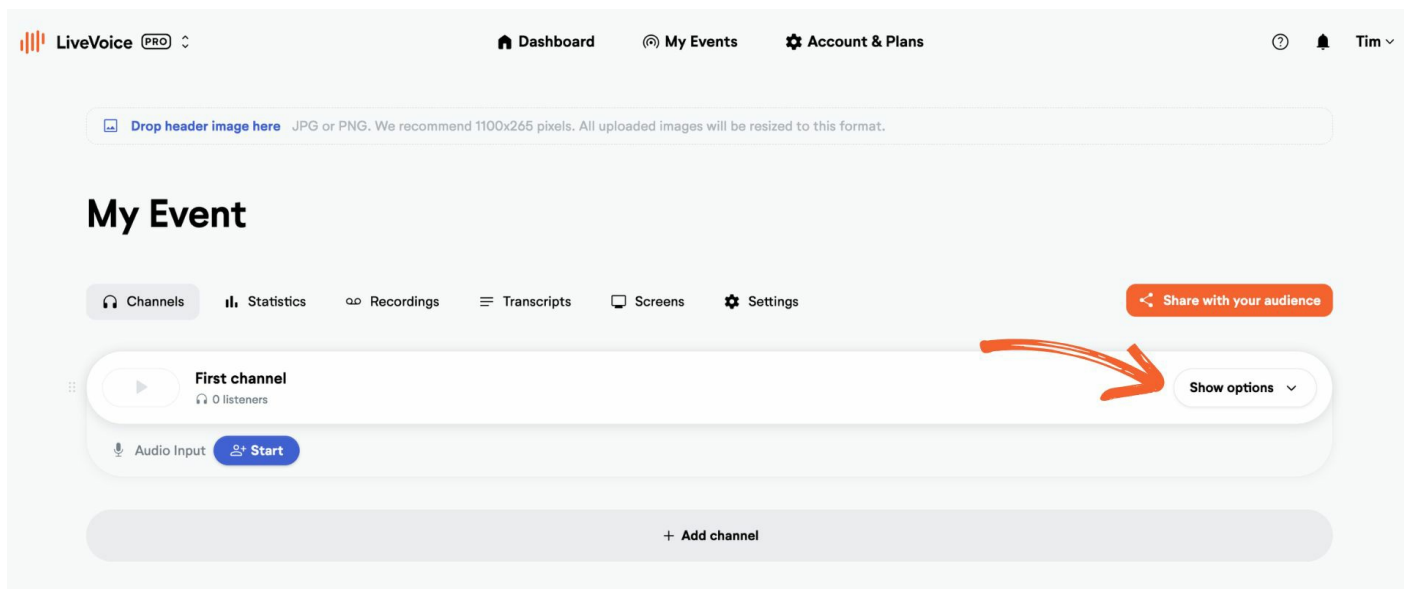

Add more channels to your event as you need. Each event can have an unlimited number of channels.