

How to: Live video for interpreters

Offer RSI (Remote Simultaneous Interpretation) with built in real time video transmission.

[RSI](#)[Live Translation](#)[Audio Description](#)[Admin](#)[Speaker](#)

With **LiveVoice PRO** you can provide a real time video and audio feed to interpreters directly within LiveVoice. In fact, you **can make any channel to a video channel** in order to stream not only audio, but also video **to other speakers** (like interpreters).

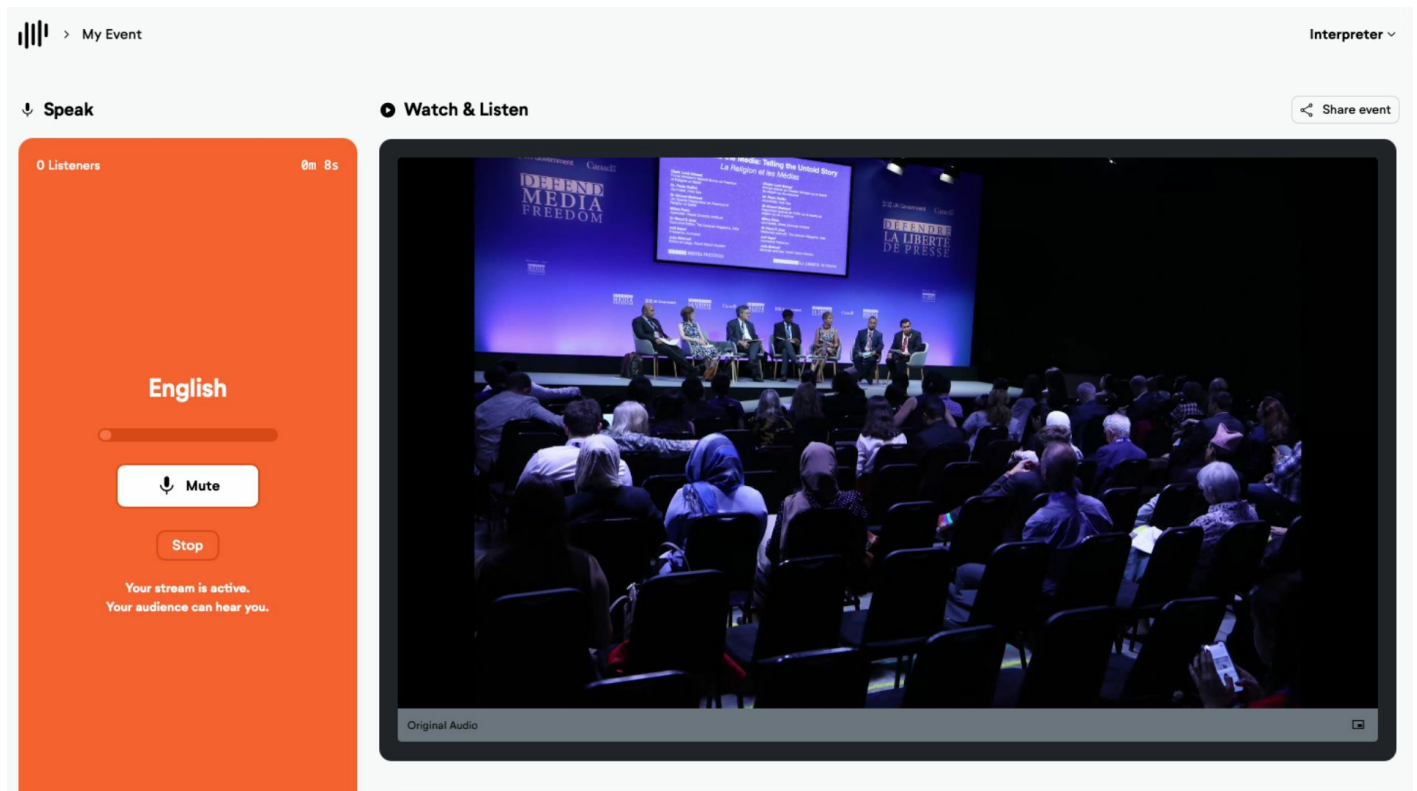

Here is how it works:

1: Activate video option for the channel

Go to “Edit Channel” of the channel you want to make a video channel and enable the “Make it a video channel” feature.

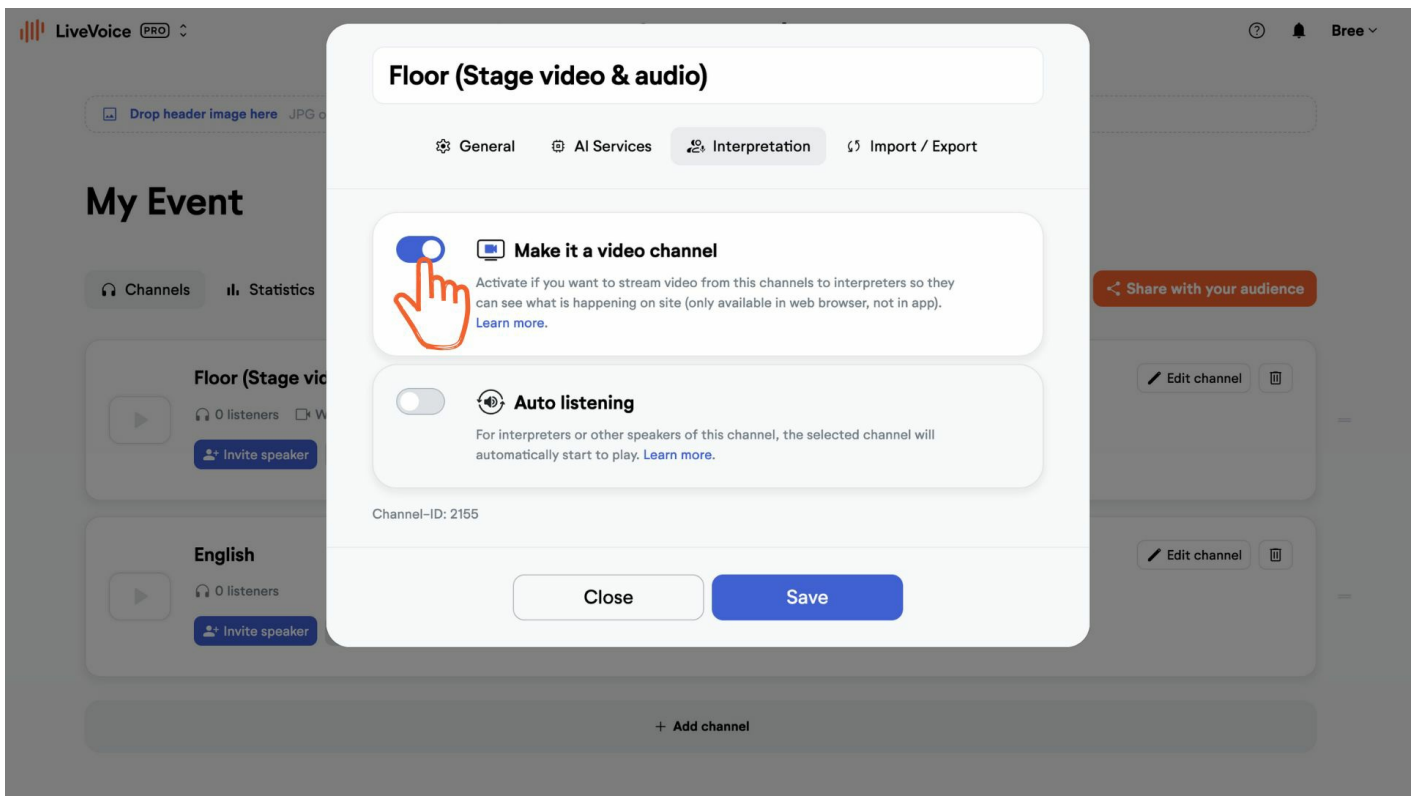

2: Open video channel in web browser

Share the speaker link of the video channel with your AV technician. You find the speaker link as admin under "Invite speaker". With this link or the code, the AV technician can join on the computer that is used to send the video from the location.

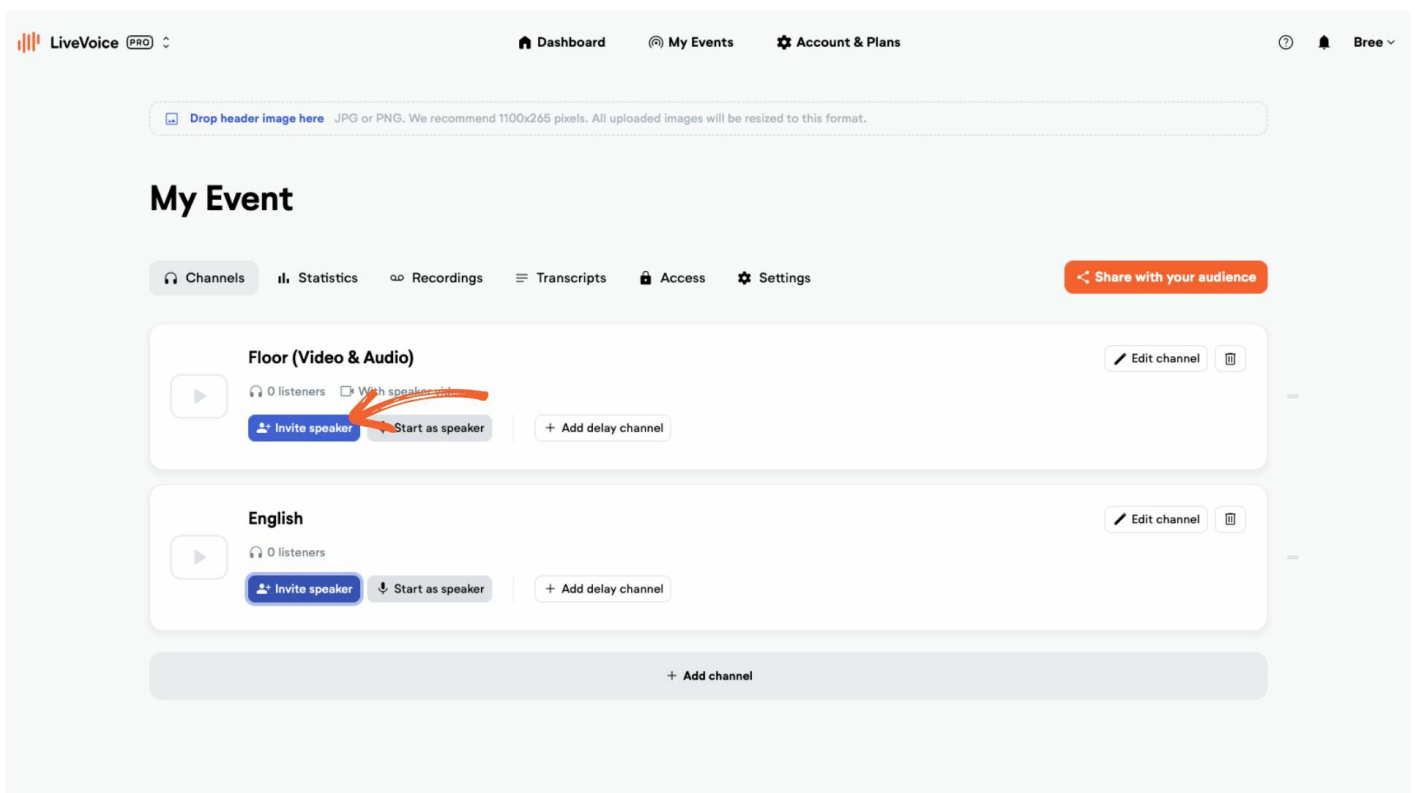

3: Start streaming with video channel

On the computer used on site, choose the right video and audio input. The video preview will be displayed in the bottom left corner.

Then hit “Start”. When the interface turns orange you are live.

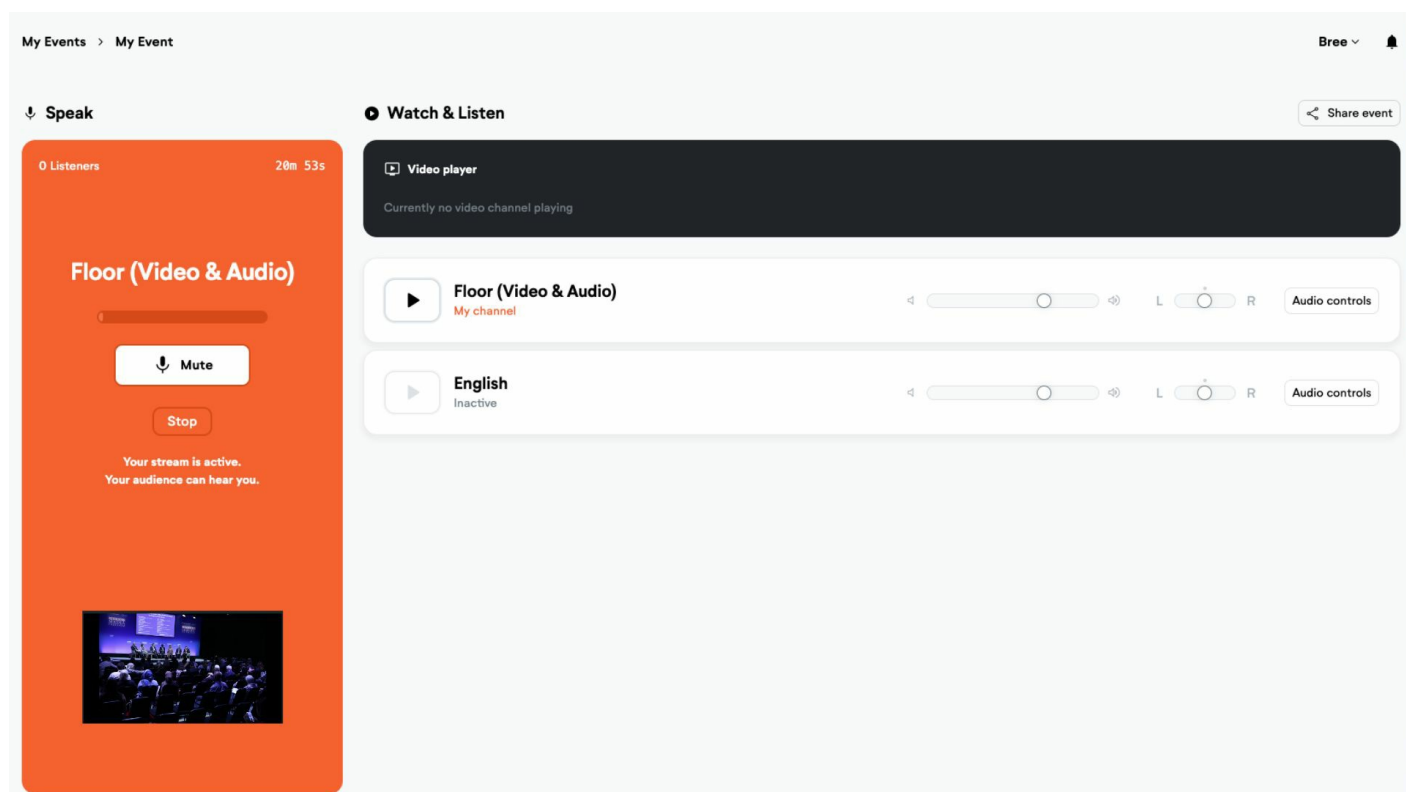
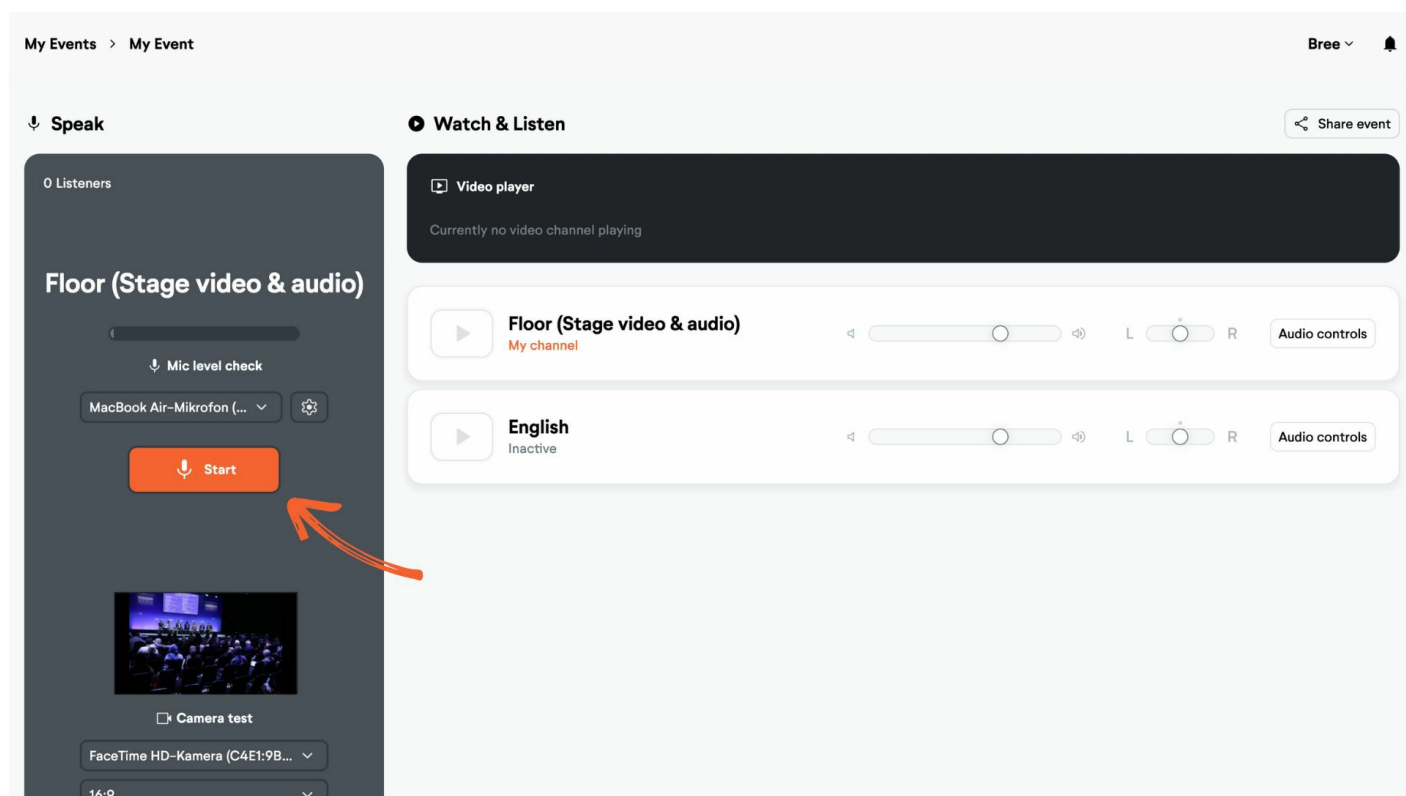

Interpreters can now watch and listen

When interpreters log in to their speaker interface, they can now click play on the “Listen in & watch” button. The video will be displayed on the top of their page.

Speak

Watch & Listen

Share event

0 Listeners

0m 8s

English

Mute

Stop

Your stream is active.
Your audience can hear you.

