

# Routing channels within LiveVoice

How to route a channel of one event to a channel of another event.

Advanced

Live Translation

Admin

**Available in: PRO with PLUS**

To route a channel of one event to a channel of another event within LiveVoice, you can do that by using the PRO Feature "Audio Import" together with the PLUS feature "Audio Export". If you are interested in this please [get in contact](#) with us.

## Setup

### Step 1: Go to the event you want to import/route *to*.

Choose RTP with Opus, and copy the URL and port.

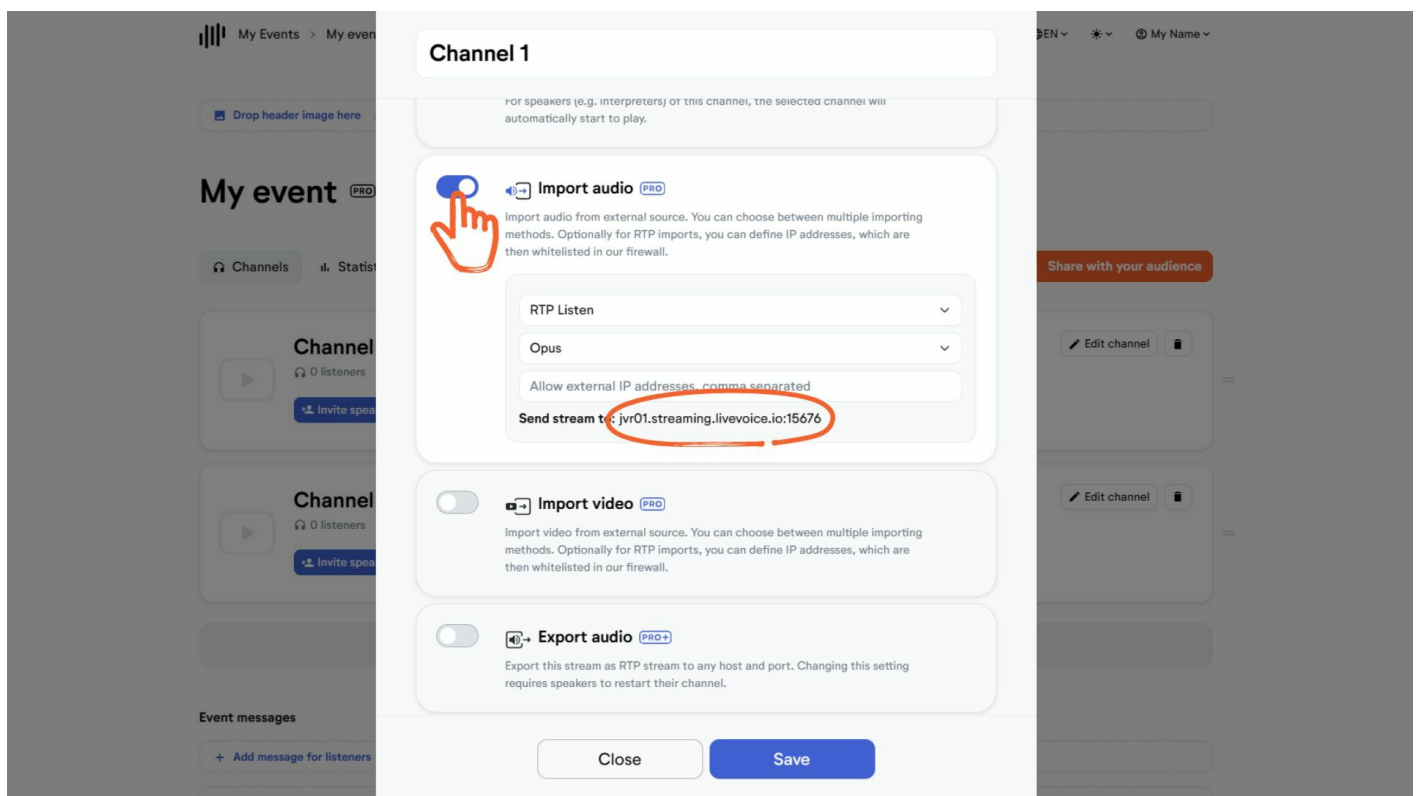

### Step 2: Go to the event you want to export *from*.

Enter the URL and port to the channel of the event you want to export.

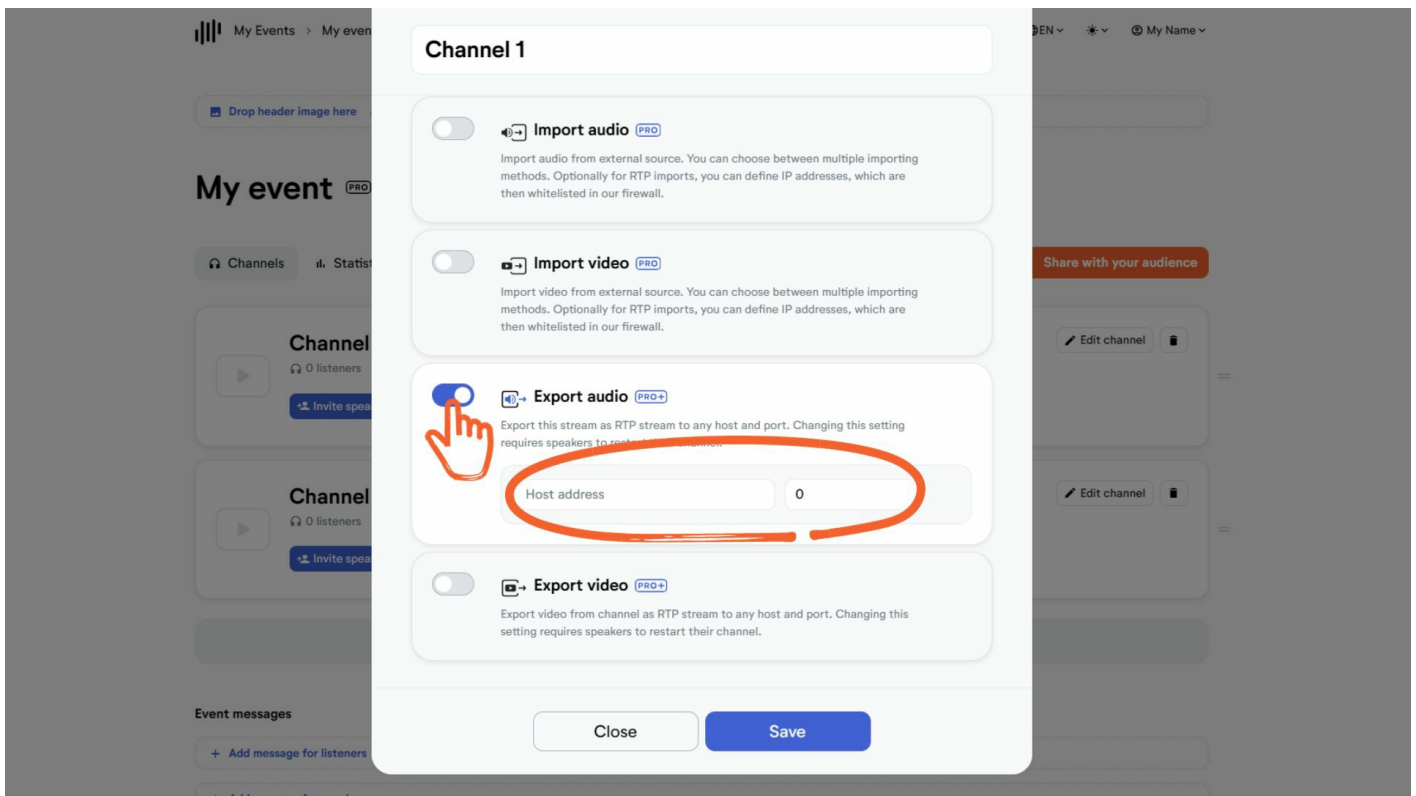

### Step 3: Start importing.

Go to the channel again you want to import to and click "Start import".